

# Endura Flap for Doors

## Installation Instructions

### Tools & Materials Required

This package contains:		Tools required:
<p><i>For single flap door mounts:</i></p> <ul style="list-style-type: none"> <li>1 flap frame</li> <li>1 trim frame</li> </ul> <p><i>For double flap door mounts:</i></p> <ul style="list-style-type: none"> <li>2 flap frames</li> <li>1 tunnel (connected to one flap frame)</li> <li>1 tube of silicone</li> </ul>	<p><i>For both single and double flap door mounts:</i></p> <ul style="list-style-type: none"> <li>8 hole plugs</li> <li>4 open barrel nuts</li> <li>4 1-3/4 inch screws</li> <li>4 2-1/4 inch screws</li> <li>2 weather-strips</li> <li>1 plastic screw</li> <li>1 warranty information</li> <li>1 installation template</li> </ul>	<ul style="list-style-type: none"> <li>pencil,</li> <li>drill with</li> <li>3/8 inch drill bit</li> <li>level</li> <li>jigsaw or reciprocating saw</li> <li>Phillips head screwdriver</li> <li>slotted screwdriver</li> <li>stud finder</li> </ul>

### **Installation Instructions**

1. Tape the provided template to the door. The top edge of the cut-out line should be 1-1/4 inch (or more) above the dog's withers (shoulders) for the single flap door mount, and 2 inches for the double flap wall mount. Be careful not to unduly reduce the strength of the door by cutting too close to the bottom of the door. Level the top edge of the cut-out line as shown in Figure 1.

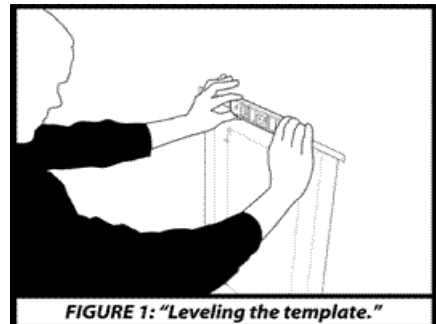

2. Mark the hole centers for the four holes and remove the template.

3. Drill the four 3/8 inch holes as shown in Figure 2.

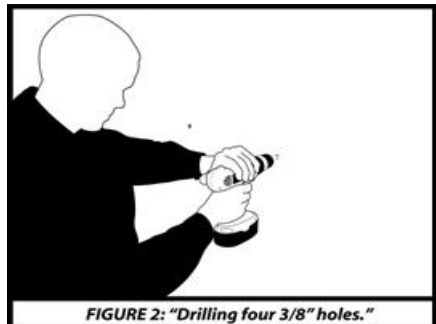

4. Draw the cut-out lines using a straight edge as shown on the template.

5. Cut along the line as shown in Figure 3.

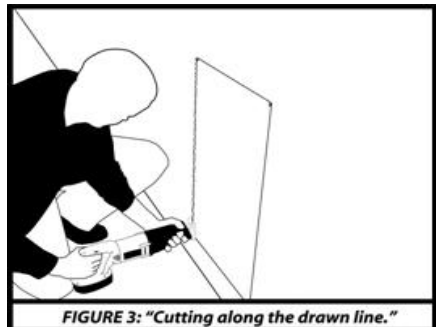

6. Install the weather-stripping into the groove on both frames

7. If a single flap door mount, place the pet door trim frame on the outside of the door and the flap frame on the inside. If a double flap door mount, place the flap frame with the tunnel attached on the inside and the other flap frame outside.

8. Select the longer set of screws for 1-3/4 inch doors and the shorter set for 1-3/8 inch doors. Insert these into the pet door from the inside. For doors with a thickness of less than 1-3/8 inch, see special instructions.

9. Install the barrel nuts from the outside. Installing the barrel nuts can be difficult. To assist in holding on to the barrel nuts, use the plastic screw. Force the plastic screw into the barrel nut until you hear it click as shown assembled in Figure 4. It can then be mated to the frame screw. Start all four screws and barrel nuts as shown in Figure 5, but do not tighten.

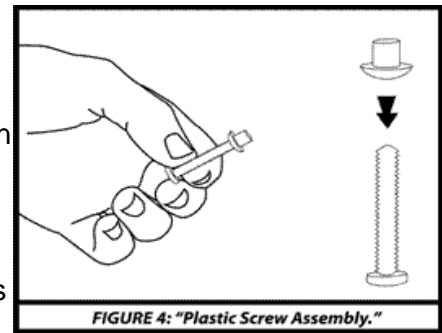

10. Before tightening down the screws, check that the pet door is level and adjust as needed.

11. Tighten the screws until the weather-stripping compresses and the pet door touches the door. Do not over tighten.

12. Hammer the hole covers into the frame using the wooden end of a hammer (or similar non metal tool).



13. Apply silicone along the inside of the tunnel where it mates with the flap frames to seal your pet door from the elements. Failure to seal your pet door can lead to severe water damage.

---

**See Next Page for Special Installation Instructions for doors less than 1-3/8" Thick**

## Special Installation Instructions for doors less than 1-3/8" Thick

**Tools Required: hacksaw or jigsaw**

If your door is less than 1-3/8 inches thick, you must cut down the trim frame so that your door mount will fit

1. Remove the four screws from the trim frame as shown in Figure 1. Pull apart the trim frame. **Do not**
2. **If your door is between one inch and 1-3/8 inches thick**, cut the trim frame at the first line (about 3/8
3. **If your door is between 1/2 inch and one inch thick**, cut all four trim frame pieces at the line 3/4 inch
4. Reassemble the flap assembly.

